

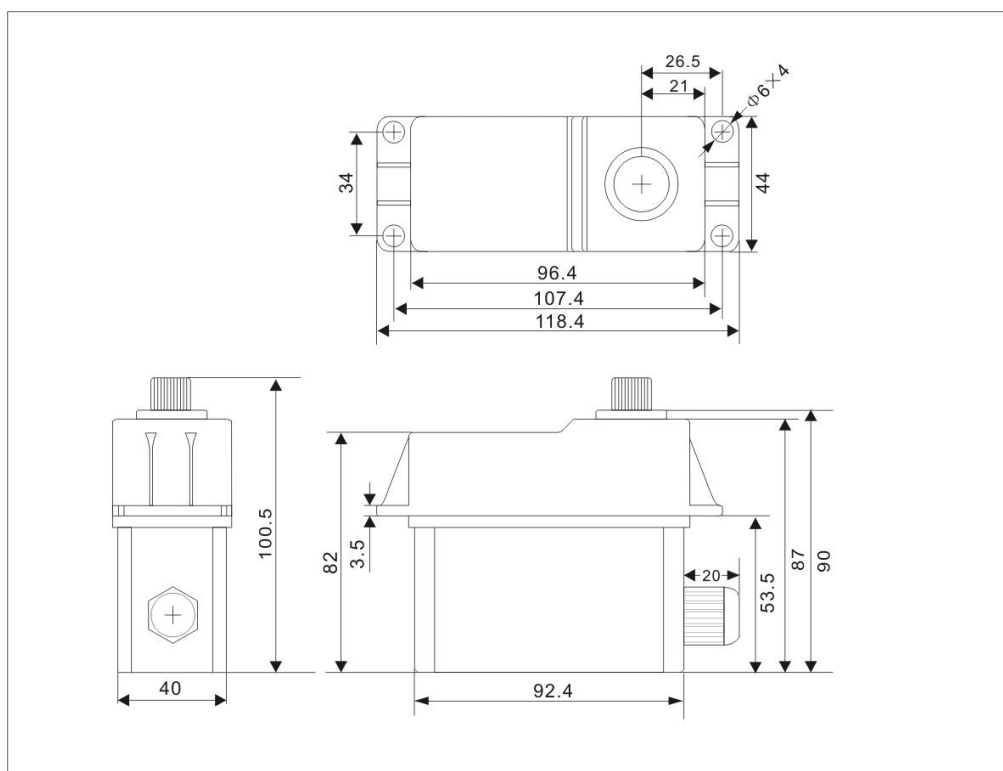

X50-12-150

Technical Specification

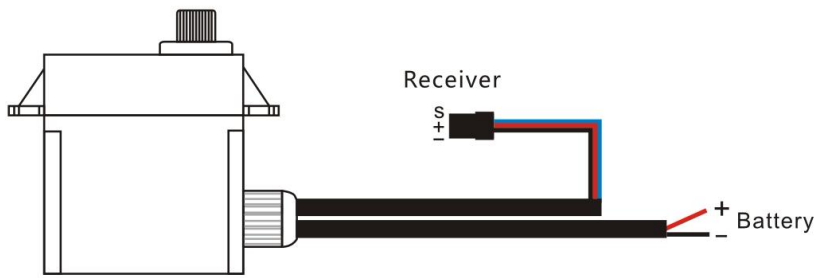



Operating Data

	X50-12-150
Operation Voltage(rated)	DC12V
Operation Voltage Range	DC8.4V-12V
Torque	100Kg.cm@8.4V
	158Kg.cm@12V
Speed	0.16sec/60 °@8.4V
	0.13sec/60 °@12V
Travel Angle	±45° when 1000-2000us
Operating Temperature Range	-20°C……+65°C

Performance

@12V

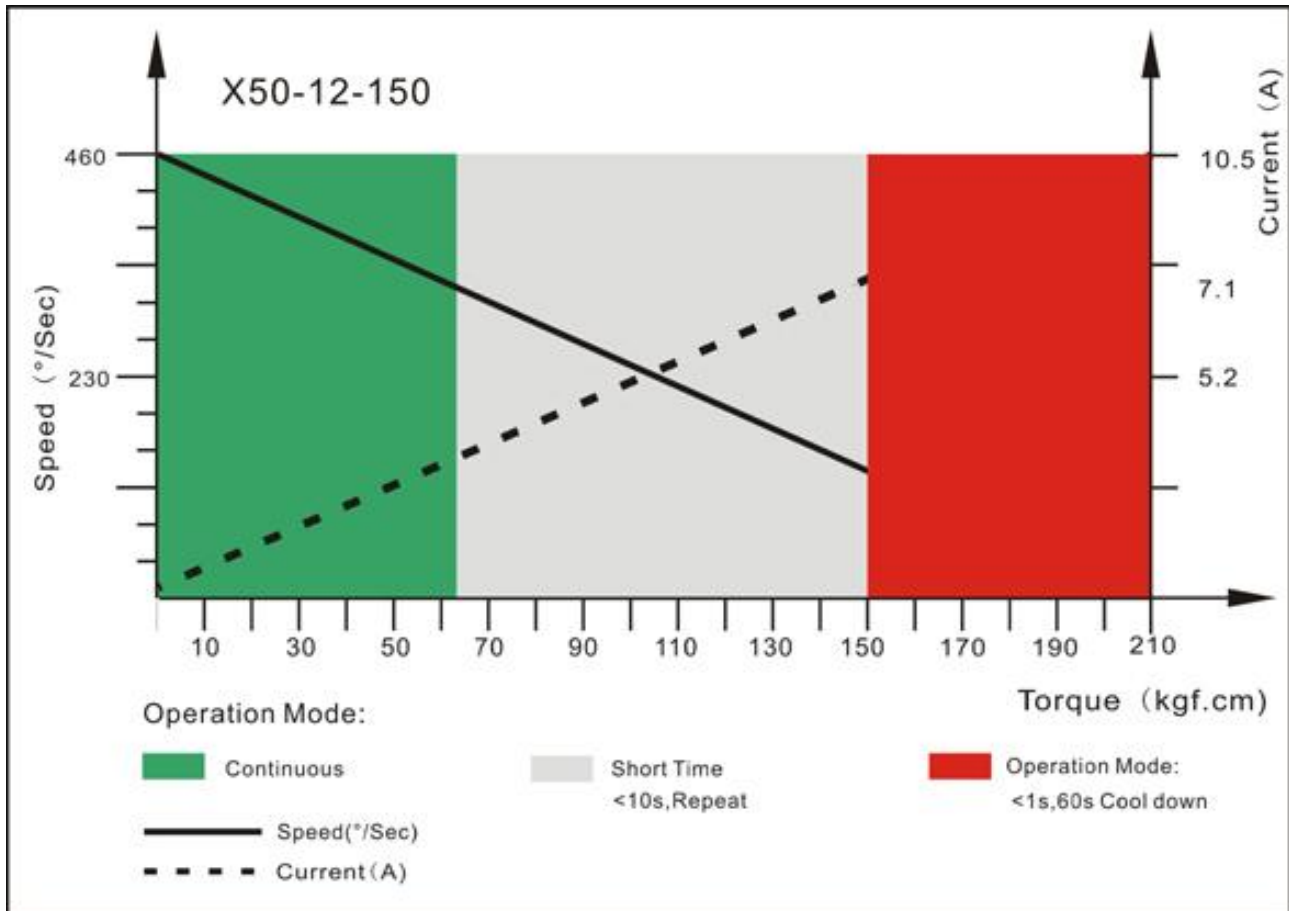

PWM Command Signal

PWM	X50-12-150
Pulse Lengths	900-2100us
Pulse Lengths for Position -45° /center/ $+45^{\circ}$	1000us/1500us/2000us
Resolution	<2us

Materials and protective features

Case Material	Aluminum Alloy
Splash Surface Treatment	
Salt Water Resistance	
EMI/RFI Shielding	
Motor Type	Brushless
Gear Set Material	Steel
Position Sensor	Potentionmeter
Position Feedback	Optional
Shielded Connecting Cable	

Dimensions

Case Dimensions	96.4*44*90mm
Weight	585g